

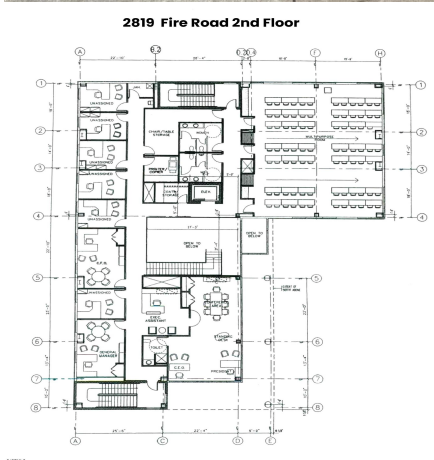

 *Priced at*
\$27

About the Property

Exceptional Class A Office Space - Widely regarded as one of the finest office buildings in the area. This premier property offers outstanding accessibility throughout Southern New Jersey. Approximately 7,500± SF is available on the second floor with convenient elevator access. A prestigious foyer featuring floor-to-ceiling windows creates a striking first impression and a highly professional environment. The owner is open to leasing a portion or the entire floor plate, which includes multiple private and executive offices, as well as a large flexible multi-purpose room that can be divided into three sections via retractable walls - ideal for training, classrooms, or large meetings. Asking Rate: \$27 PSF plus utilities & load factor.



Features

- 1 Bathroom
- Heat Fuel: Forced Air • Heat Fuel: Gas-Natural
- Heat Fuel: Multi-Zoned
- Fire Sprinkler System
- Other (See Remarks)
- Security System
- Elevator Pass
- Handicap Features
- Restroom
- Smoke/Fire Alarm

Give me a call!

www.monihan.com